

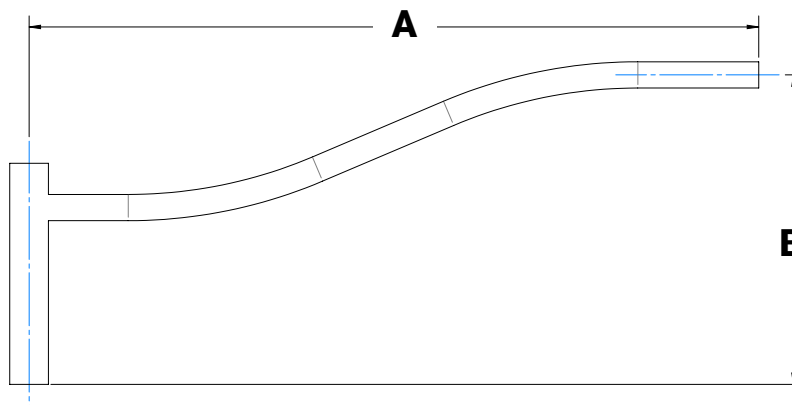

Architectural Arm 16 is constructed of extruded aluminum tubing. This mast arm integrates with poles or tenons of 3-1/2", 4", 4-1/2", or 5" OD and is secured with 3/8" stainless steel Allen set screws.

Contact NLS for custom configuration or others mounting options. Arms are designed, tooled, fabricated and assembled in the USA.



MODEL	A	B	EPA SGL	EPA DBL
A16-S	48 in.	28 in.	.60	.97
A16-L	60 in.	28 in.	.74	1.21
A16-XL	72 in.	28 in.	.82	1.37
A16-XXL	84 in.	28 in.	.94	1.57

MODEL	SGL	DBL
A16-S	10.42 lbs	16.99 lbs
A16-L	12.81 lbs	21.01 lbs
A16-XL	14.18 lbs	23.99 lbs
A16-XXL	13.80 lbs	22.64 lbs



Project Name:

Type:

ARCHITECTURAL ARM 16 ORDERING GUIDE

Cat#	Mounting	Pole Diameter	Color
Architectural Arm 16 Small (A16-S)	Single (SGL)	3-1/2" Round OD (312R)	Bronze Textured (BRZ)
Architectural Arm 16 Large (A16-L)	Double 180° (D180)	4" Round OD (4R)	White Textured (WHT)
Architectural Arm 16 Extra Large (A16-XL)	Wall Mount (WM) ¹	4-1/2" Round OD (412R)	Smooth White Gloss (SWT)
Architectural Arm 16 Extra Extra Large (A16-XXL)		5" Round OD (5R)	Silver Metallic (SVR)
			Black Textured (BLK)
			Smooth Black Gloss (SBK)
			Graphite Textured (GPH)
			Grey Textured (GRY)
			Green Textured (GRN)
			Hunter Green Textured (HGN)
			Custom (CS)

NOTES:

1. Only Available with Architectural Arm 16 Small (A16-S)



701 Kingshill Place, Carson, CA 90746
Call Us Today (310) 341-2037

nlsighting.com